

Requirements:

- WT HEPA Filter Kit ([page A-7](#))
- Torque driver with #2 Phillips bit
- 70% isopropyl alcohol solution and soft cloth (if replacing gasket in filter enclosure)

To replace the filter:

1. If the power cord is secured around the back of the unit, unwind it completely.
2. Position the warming unit on its front so the bottom of the unit is accessible ([Figure 5-2](#)).

Figure 5-2. Filter Enclosure and Power Cord Connection

TEM_10241_A

- | | | | |
|---|------------------------------|---|----------------------------|
| 1 | Filter Enclosure | 3 | Power Cord Routing Bracket |
| 2 | Filter Enclosure Screws (x3) | 4 | Power Cord Connector |

3. Remove the three screws from the filter enclosure. Lift the enclosure away from the unit, disengaging the power cord from its socket. Set the enclosure and attached power cord aside.



Caution:
The institution should follow local governing ordinances and recycling instructions regarding disposal or recycling of filter and device components or end of life of the product.

4. Remove the filter (*Figure 5-3*). Dispose of the filter as required by local governing ordinances.

Figure 5-3. HEPA Filter



TEM_10242_A

5. Place the new filter on the unit.

6. Before placing the filter enclosure back on the unit, check the circular gasket inside the enclosure (*Figure 5-4*). If the gasket is worn or damaged, replace it as follows:
 - a. Peel the gasket off the enclosure.
 - b. Use a soft cloth dampened with a solution of 70% isopropyl alcohol to remove any adhesive remnants from the surface. Make sure that the surface is completely dry before proceeding.
 - c. Remove the backing from the new gasket to expose the adhesive.
 - d. Center the gasket around the raised area in the enclosure, and press around the entire gasket to adhere.

Figure 5-4. Gasket inside Filter Enclosure



TEM_10243_A

7. Place the filter enclosure back on the unit, aligning the power cord with its socket. Make sure that the enclosure is fully seated on the unit.
8. Press the power cord connector into the socket so that it is fully connected (*Figure 5-2* on page 5-5).
9. Reinstall the three screws in the filter enclosure. Tighten the screws to 1.2 to 1.6 N-m (10.6 to 14.2 lb-in).

10. Set the unit upright, and plug the power cord into the power outlet.
11. Reset the filter counters as follows:



- a. Press the **On/Standby** key. The Replace Filter screen appears ([Figure 5-5](#)).

Figure 5-5. Replace Filter Screen



TEM_10101_A



- b. Press the **Replace Filter** key. The Filter Information screen appears ([Figure 5-6](#)).

Figure 5-6. Filter Information Screen - Filter Expired



TEM_10272_A



- c. Press the **Filter Reset** key.
- d. Press the key code as described in [Service Screen Access](#) on page 7-2. The filter counters are reset to 365 days and 2000 hours.



- e. Press the **On/Standby** key to return to Standby mode. Press the **On/Standby** key again and verify that the Main screen appears ([Figure 5-7](#)) rather than the Replace Filter screen.

7.4 Service Screen Access

The warming unit provides screens for performing functions restricted to service personnel. These screens are protected by a key code.

When you see the message "Enter Key Code" press the keys indicated in [Figure 7-1](#) simultaneously to access these screens.

Figure 7-1. Key Code Screen

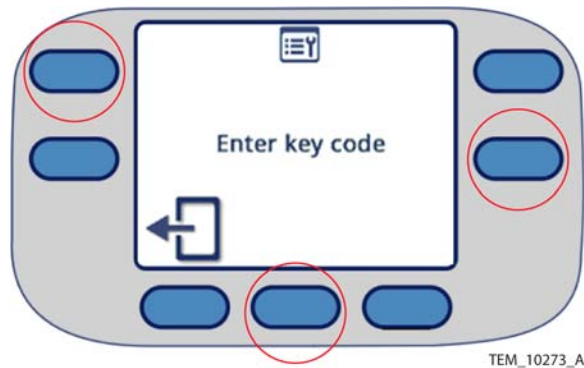

TEM_10273_A

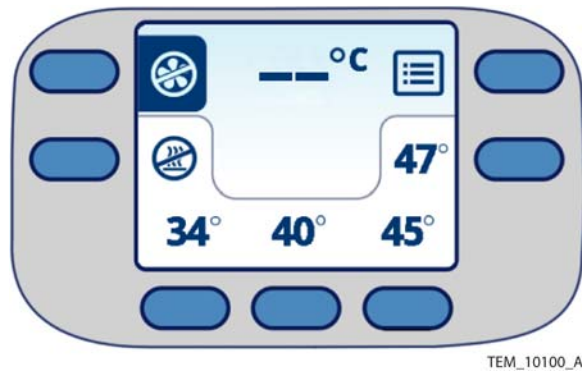
Figure 5-7. Main Screen at Power-On

12. Power off the warming unit by pressing the **On/Standby** key. Disconnect the power cord from the outlet.
13. Wrap the power cord around the back of the unit, and secure it with the attached strap ([Figure 5-8](#)).

Figure 5-8. Power Cord Wrapped and Secured